

Bayfield County Forestry & Parks Department

Forester: Joanna Deegan	Twp: 45N	Range: 9W	Sec: 1 & 12	Estimated Volumes: <table border="1"> <thead> <tr> <th>Species</th> <th>4" Cords</th> </tr> </thead> <tbody> <tr> <td>White Pine</td> <td>370</td> </tr> <tr> <td>Red Pine</td> <td>460</td> </tr> <tr> <td>Jack Pine</td> <td>140</td> </tr> <tr> <td>Mixed Hardwood</td> <td>40</td> </tr> </tbody> </table> <p>*Mixed Hardwood approximately: 50% scrub oak, 40% soft maple, 5% white birch, and 5% aspen. *Avg. diameter of white pine: 20" dbh *Ava. diameter of red pine: 18" dbh</p>	Species	4" Cords	White Pine	370	Red Pine	460	Jack Pine	140	Mixed Hardwood	40
Species	4" Cords													
White Pine	370													
Red Pine	460													
Jack Pine	140													
Mixed Hardwood	40													
Acre: 67	Township: Barnes – North Central													
Soil: Sand	Compartment: 161													
Regen Code: Planting at rotation age	Tract Number: 45-13													
Topography: gentle rolling	Contract Number:													
Scale: 4 in. = 1 mile														

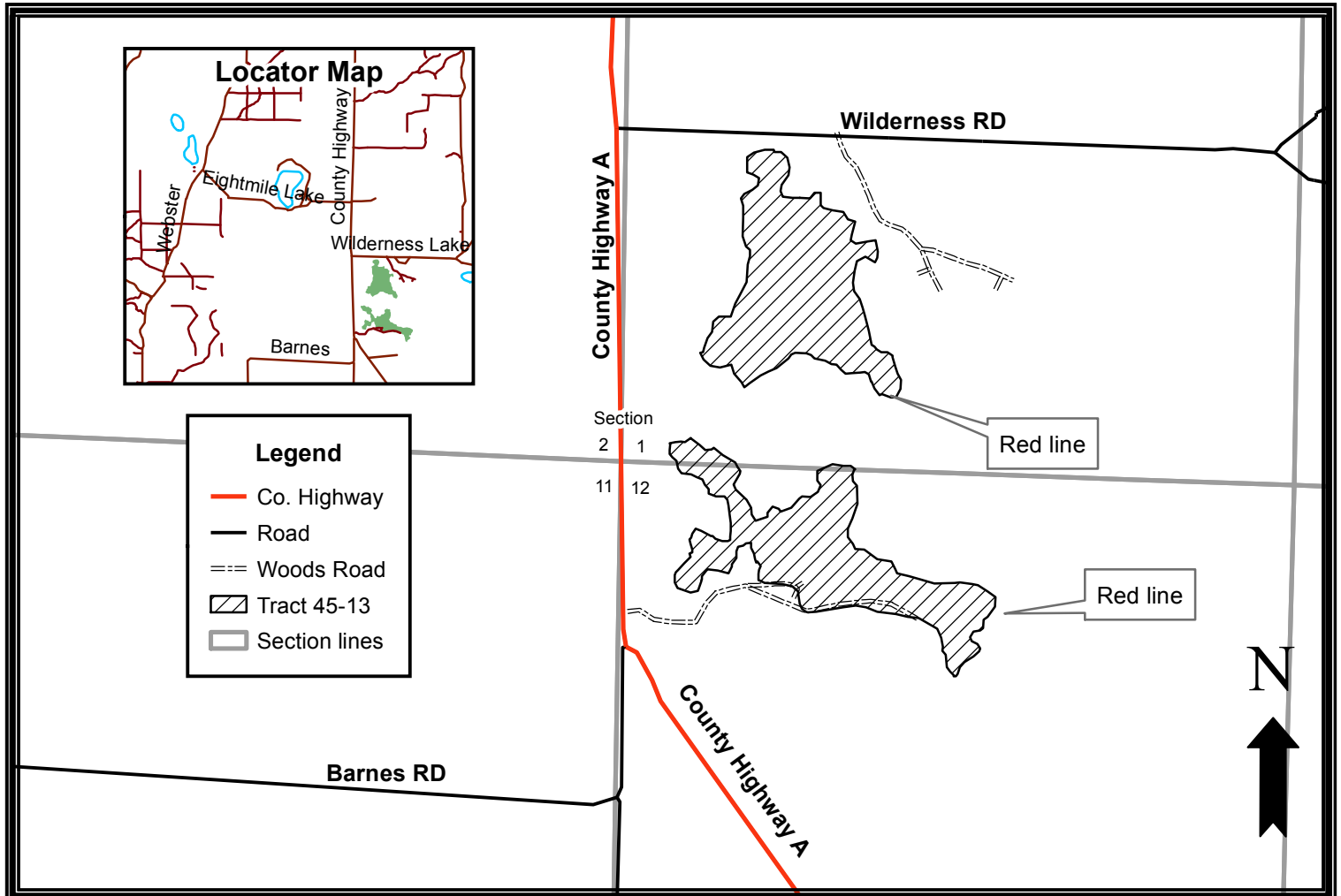

Harvest requirements:

- Sale is being sold on a ticket scale basis. Whole-tree harvesting and/or utilization of tops less than 4" diameter will not be allowed.
- Cut all hardwood and jack pine within the sale area down to 2 inches DBH. Harvest all trees marked with orange paint. Leave all white spruce.
- Do not cut snags, except for those that pose a safety hazard to logging operations.
- Prior to moving equipment to and from the sale area, scrape soil and debris from exterior surfaces.
- This contract requires County authorization for all road/landing construction, and places a number of other requirements on road construction and closure.
- Decking of wood along town roads will not be allowed without permission from Bayfield County.
- Do not damage any survey monumentation.
- Harvested pine cannot be kept on the Bayfield County Forest for more than three weeks from May 1st to August 31st.