

# Bayfield County Forestry and Parks

Forester: Joanna Bietka			Acres: 22	Estimated Volumes:								
Twp: T45N	Range: R9W	Section: 8	Compartment: 156	<table border="1"> <thead> <tr> <th>Species</th> <th>4" Cords (avg. dbh =18")</th> </tr> </thead> <tbody> <tr> <td>Red Pine</td> <td>430</td> </tr> <tr> <td>Aspen</td> <td>70</td> </tr> <tr> <td>Mixed Hardwood</td> <td>30</td> </tr> </tbody> </table>	Species	4" Cords (avg. dbh =18")	Red Pine	430	Aspen	70	Mixed Hardwood	30
Species	4" Cords (avg. dbh =18")											
Red Pine	430											
Aspen	70											
Mixed Hardwood	30											
Township: Barnes			Stand: 3									
Soil: Sand	Reforestation Code: Artificial Regeneration		Tract Number: 41-12									
Topography: Flat	Scale: 4 inches = 1 mile		Contract Number:	<p>**Mixed hardwood includes 42% white birch, 50% scrub oak, and 7% red maple. **Red pine volume includes 20 cords of jack pine and 40 cords of white pine.</p>								

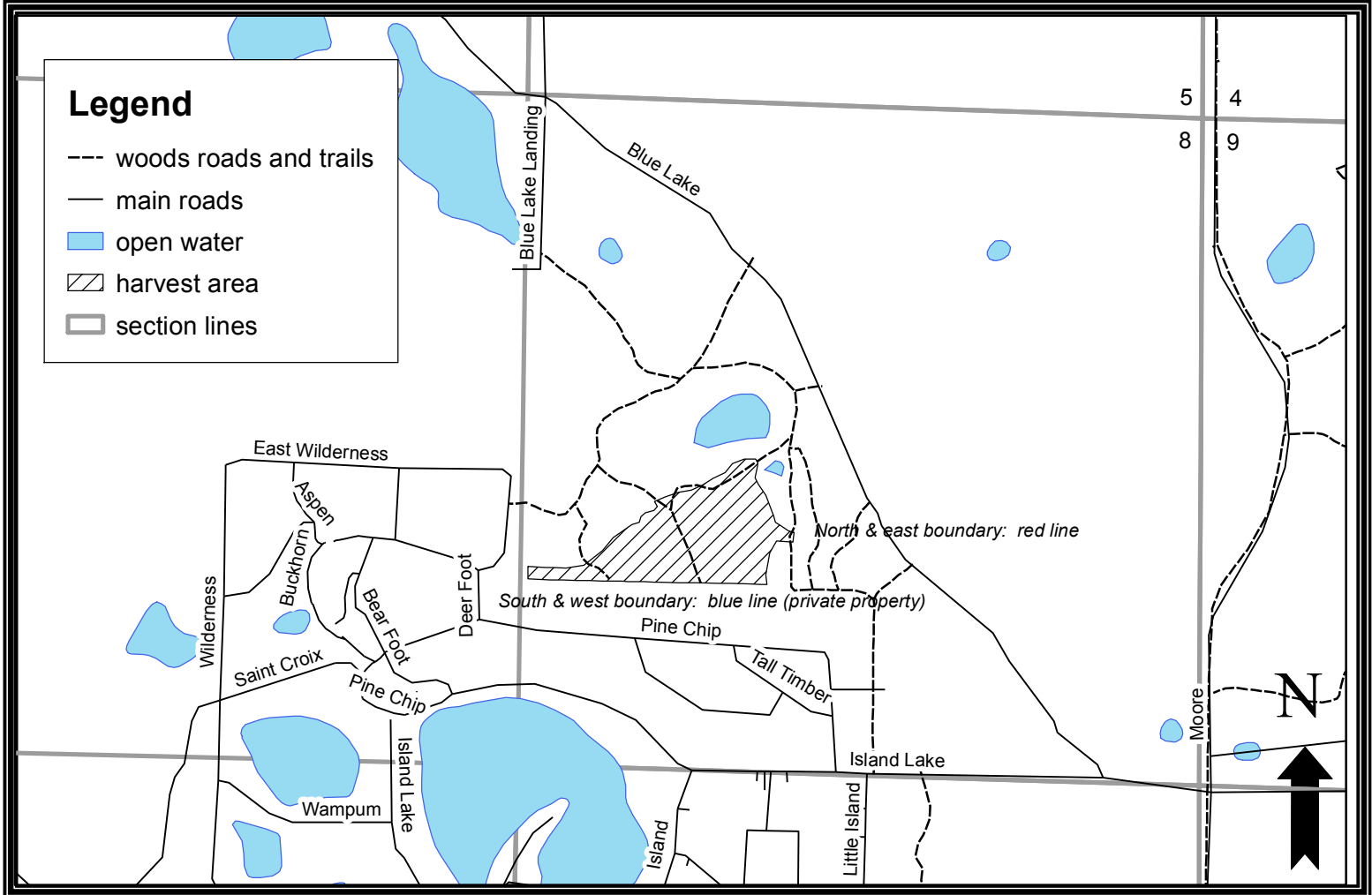

## Harvest requirements:

- This is a ticket sale.
- This is a clear cut in a natural red pine stand with average diameter of 18 inches.
- Whole-tree harvesting and/or utilization of tops less than 4" diameter will not be allowed.
- All stems must be severed, including snags, hardwood, and pine 2" dbh and larger.
- Do not damage any survey monumentation.
- Prior to moving equipment on to or off the sale area, scrape or brush debris and soil from exterior surfaces.
- Cut all snags within the sale area.
- All roads are in place. This contract requires county authorization for all road/landing construction and places a number of other requirements on road construction and closure.
- Decking of wood along town roads will not be allowed without permission of Bayfield County.
- Harvested pine cannot be kept on the Bayfield County Forest for more than three weeks from May 1<sup>st</sup> to August 31<sup>st</sup>.