

Bayfield County Forestry & Parks Department

| | | | | | | |
|---|---------------------|------------------------|---------|--------------------------|--------------------------|--------------------------|
| Foresters: Amman, Holmes, J. Neitzel | Twp: 48N | Range: 8W | Sec: 23 | Estimated Volumes | | |
| Acres: 15 | Township: Tripp | | | Species | Roundwood (cords) | Whole-Tree (tons) |
| Soil: Sand | Compartment: 98 | Stand: 24 | | Red Pine (12" Avg.)* | 206 | 602 |
| Topography: Gentle Rolling | Tract Number: 28-14 | Reforestation Code: NA | | Aspen | 5 | 11 |
| Scale: 4"=1 mile | Contract Number: | | | *Less than 1% jack pine | | |

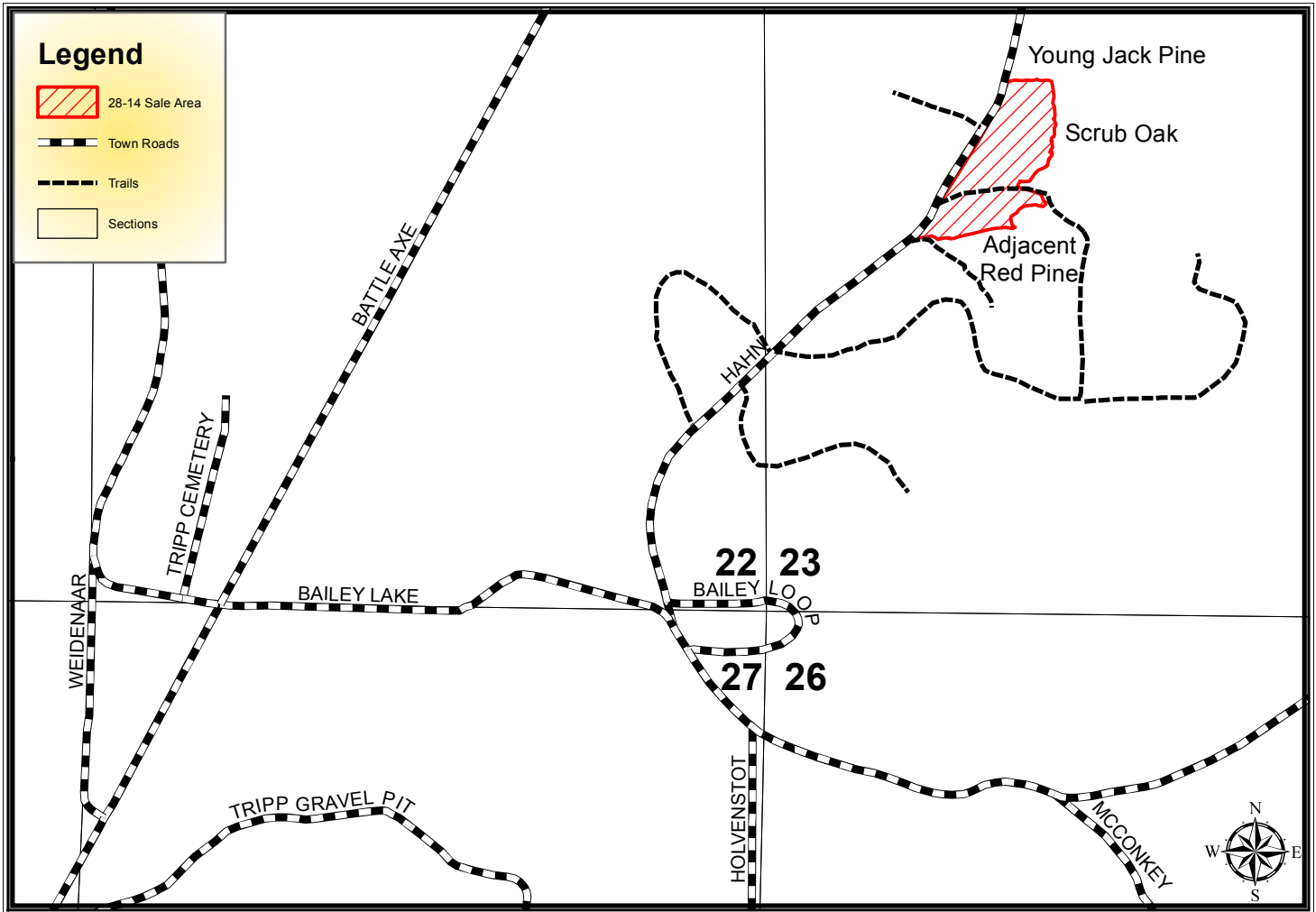

Harvest Requirements:

1 inch = 0.25 miles

- This sale is a red pine thinning being sold on a Ticket Scale Basis.
- Sale boundaries are identifiable on the ground by Hahn Road on the west, abrupt changes in timber types on the north and east, and the termination of orange-marked trees on the south.
- Harvest all orange-marked red pine, all aspen, and all jack pine within the sale area.
- If whole-tree harvested, 1 in 10 tops $\leq 4''$ in diameter must be left scattered across the site.
- Minimize damage to residual stand.
- Harvested pine cannot be kept on the Bayfield County Forest for more than 3 weeks from May 1st to August 31st.
- Do not damage any survey monuments.
- To comply with the Best Management Practices for Invasive Species: Prior to moving equipment onto or off of the sale area, scrape or brush soil and debris from exterior surfaces of the logging equipment.
- Decking of wood along town roads will not be allowed without permission from Bayfield County Forestry Department
- This contract requires County authorization for all road/landing construction and places a number of other requirements on road construction and closure. (refer to Section 17)