

# Bayfield County Forestry & Parks Department

Forester: O'Krueg, Neitzel			Acres: 28		Estimated Volumes		
Twp: 49N	Range: 5W	Sec: 10,11	Compartment: 70,72		Species	Whole Tree	Round Wood
Township: Bayview			Stand: 5,26,12			Tons	Cords
Soil: Sand		Reforestation Code: None	Tract Number: 32-14		Red Pine	876	303
Topography: Gentle rolling			Contract Number:		Spruce	34	14
					Red Oak*	28	10

\*Approx. 90% oak and 10% other hardwood

**Average Red Pine diameter = 13"**

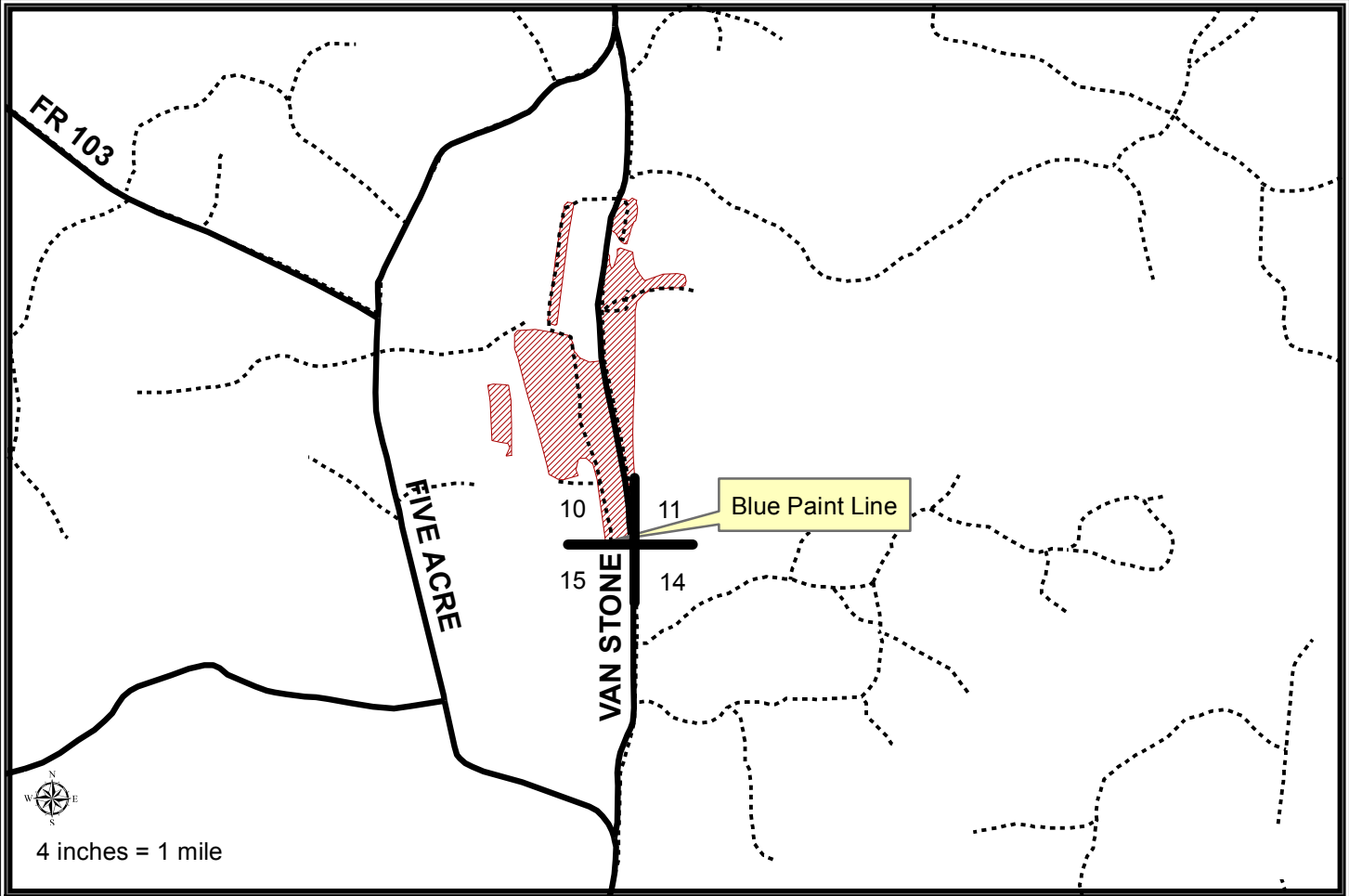

## Harvest Requirements:

- Sale is a red pine thinning being sold on a Ticket Scale Basis
- Harvest all orange marked red pine and spruce.
- Harvest all aspen, oak, and hardwood necessary for operability.
- Sale boundaries consist of blue paint line or a noticeable change in timber type.
- The blue paint on the south end of the sale indicates private property. No equipment or felled trees may cross the line.
- Do not cut snags except for those that pose a safety hazard.
- Harvested pine cannot be kept on the Bayfield County Forest for more than three weeks from May 1<sup>st</sup> to August 31<sup>st</sup>.
- To comply with the Best Management Practices for Invasive Species: Prior to moving equipment onto or off of the sale area, scrape or brush soil and debris from exterior surfaces to the extent practical.
- Decking of wood along town roads will not be allowed without permission from Bayfield County.
- If harvest will utilize the whole tree, 1 in 10 tops must be left scattered throughout the sale.
- This contract requires County authorization for all road/landing construction and places a number of other requirements on road construction and closure.