

Bayfield County Forestry & Parks Department

Forester: O'Krueg, Neitzel			Acres: 32	Estimated Volumes		
Twp: 48N	Range: 8W	Sec: 28,33	Compartment: 100	Whole Tree	*Approx. 95% Maple, 5% Other Hardwood	
Township: Tripp			Stand: 33	Species		Tons
Soil: Sand	Reforestation Code: AR-PJ		Tract Number: 11-13	Aspen**	693	**Average Aspen Diameter is 9"
Topography: Flat			Contract Number:	Scrub Oak	396	
				Mixed Hardwood*	72	
				Fir/Spruce	99	
				Jack Pine	161	
				Red Pine	37	
				White Pine	40	

4 inches = 1 mile

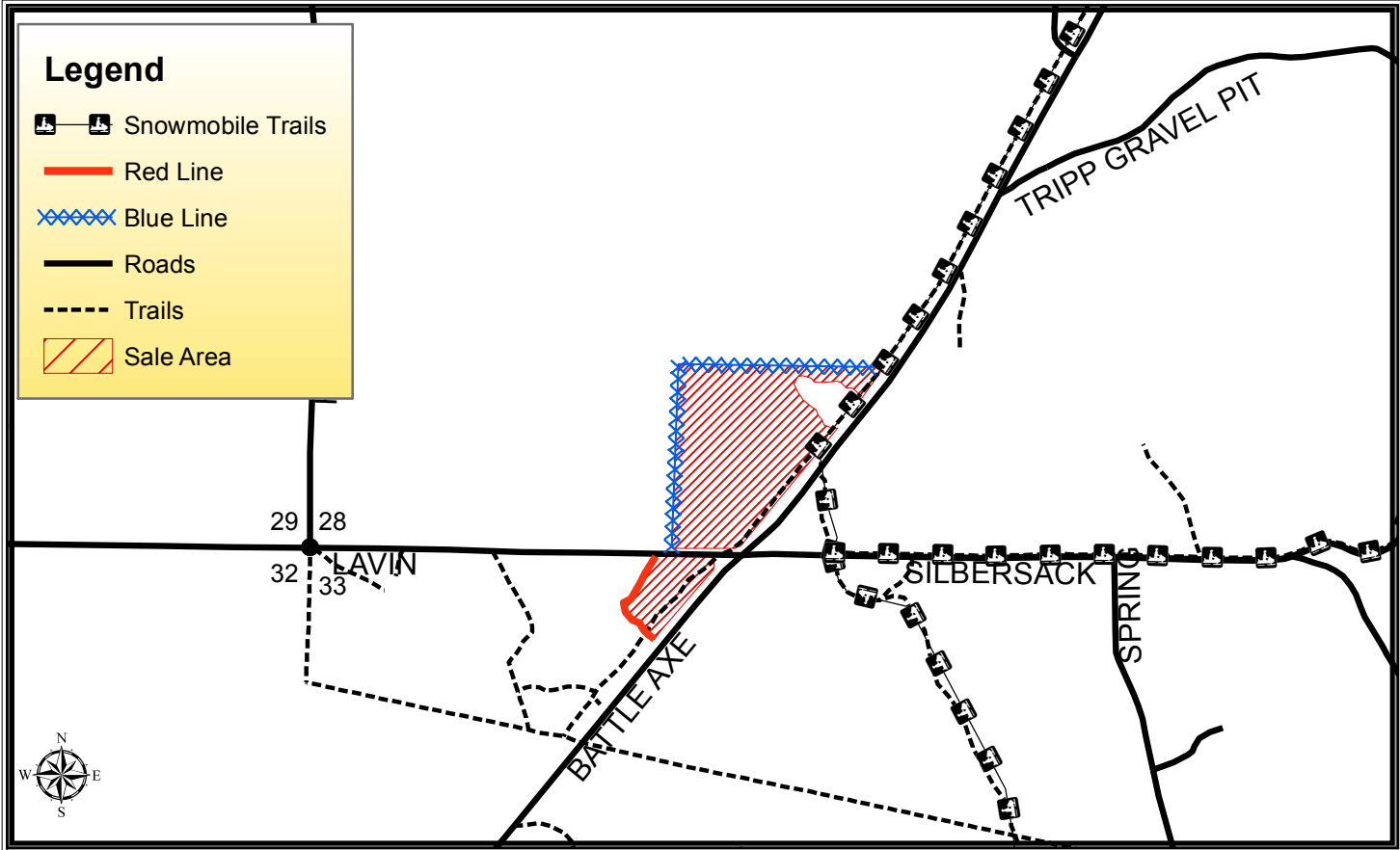

Harvest Requirements:

- Sale is a clearcut being sold on a Ticket Scale Basis
- Sale boundaries are roads, trails, red paint line, blue paint line, or noticeable timber type changes.
- Sale must be whole tree harvested. 1 in 10 tops must be left scattered throughout the sale.
- Harvest all merchantable trees. Sever all stems 2" in diameter and greater.
- Harvested Pine cannot be kept on the Bayfield County Forest for more than three weeks from May 1st to August 31st.
- All snags must be cut.
- During winter harvesting the snowmobile trail must be kept unobstructed and in a packed snow condition. The purchaser must insure that harvesting and hauling operations will not create a safety hazard to snowmobiles.
- Signage must be used on the snowmobile/ATV trail during harvest and hauling.
- To comply with the Best Management Practices for Invasive Species: Prior to moving equipment onto or off of the sale area, scrape or brush soil and debris from exterior surfaces to the extent practical.
- Decking of wood along town roads will not be allowed without permission from Bayfield County.
- This contract requires County authorization for all road/landing construction and places a number of other requirements on road construction and closure.
