

Bayfield County Forestry & Parks Department

Forester: O'Krueg, Neitzel			Acres: 48	<table border="1"> <thead> <tr> <th rowspan="2">Species</th> <th colspan="2">Estimated Volumes</th> </tr> <tr> <th>Whole Tree Tons</th> <th>Round Wood Cords</th> </tr> </thead> <tbody> <tr> <td>Aspen</td> <td>2953</td> <td>1002</td> </tr> <tr> <td>Jack Pine</td> <td>362</td> <td>132</td> </tr> <tr> <td>Mixed Hardwood*</td> <td>164</td> <td>45</td> </tr> <tr> <td>Scrub Oak</td> <td>39</td> <td>11</td> </tr> </tbody> </table>			Species	Estimated Volumes		Whole Tree Tons	Round Wood Cords	Aspen	2953	1002	Jack Pine	362	132	Mixed Hardwood*	164	45	Scrub Oak	39	11
Species	Estimated Volumes																						
	Whole Tree Tons	Round Wood Cords																					
Aspen	2953	1002																					
Jack Pine	362	132																					
Mixed Hardwood*	164	45																					
Scrub Oak	39	11																					
Twp: 46N	Range: 9W	Sec: 10	Compartment: 137																				
Township: Hughes			Stand: 29																				
Soil: Loamy Sand	Reforestation Code: Nat. Regen.	Tract Number: 18-13																					
Topography: Gentle Rolling			Contract Number:																				

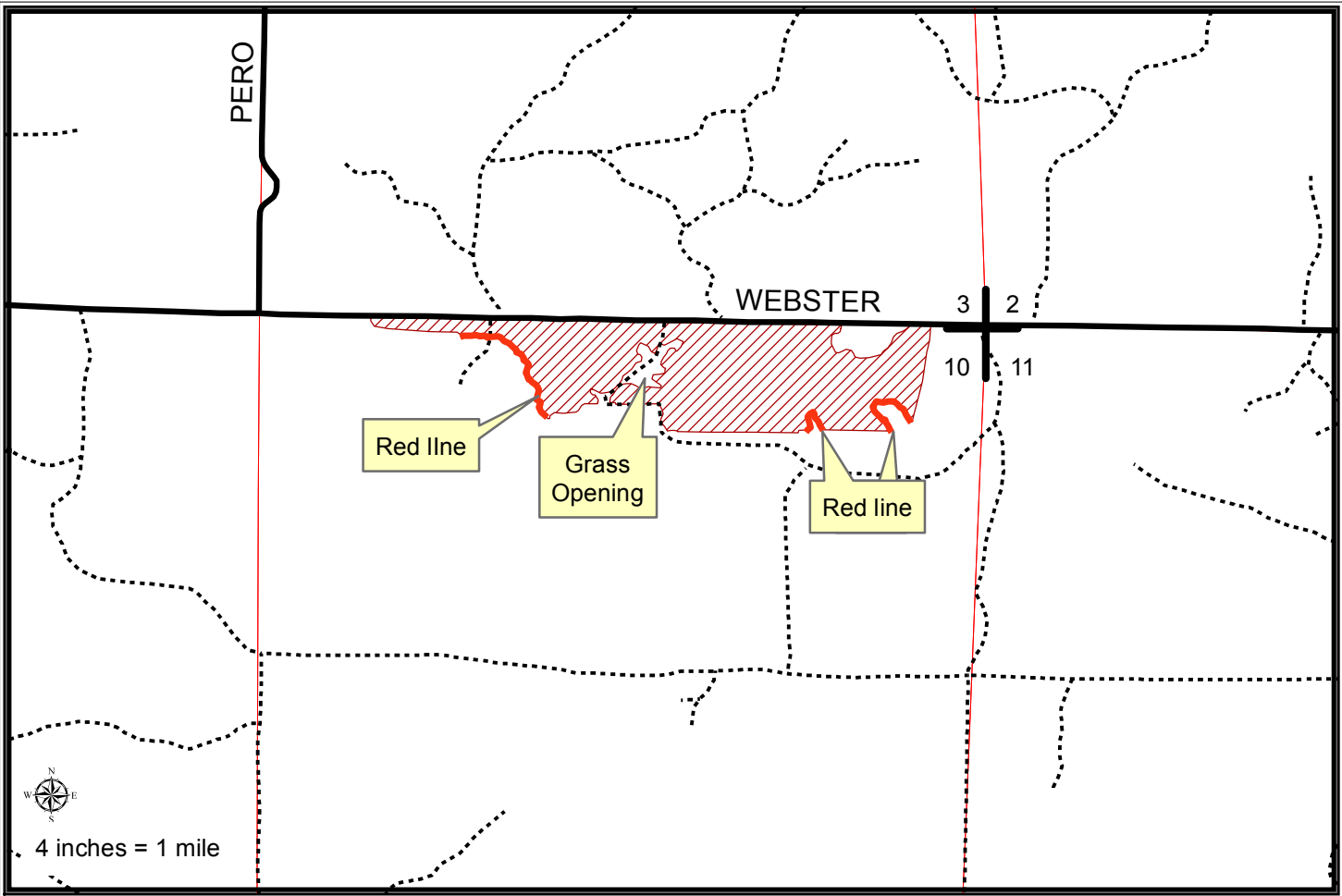

Harvest Requirements:

- Sale is a clearcut being sold on a Ticket Scale Basis
- Sale boundaries consist of red paint line, roads, or an abrupt change in timber type.
- Harvest all unmarked merchantable jack pine. Leave all purple marked jack pine and other conifer.
- Harvest all merchantable hardwood
- Sever all hardwood stems 2" in diameter and greater.
- Do not cut snags except for those that pose a safety hazard.
- Harvested pine cannot be kept on the Bayfield County Forest for more than three weeks from May 1st to August 31st.
- To comply with the Best Management Practices for Invasive Species: Prior to moving equipment onto or off of the sale area, scrape or brush soil and debris from exterior surfaces to the extent practical.
- Decking of wood along town roads will not be allowed without permission from Bayfield County.
- If harvest will utilize the whole tree, 1 in 10 tops must be left scattered throughout the sale.
- This contract requires County authorization for all road/landing construction and places a number of other requirements on road construction and closure.
