

# Bayfield County Forestry & Parks Department

Forester: O'Krueg, Holmes, Neitzel, Hillebrand			Acres: 46	Estimated Volumes			
Twp: 50N	Range: 4W	Sec: 29	Compartment: 64	Species	Whole Tree	Round Wood	Logs
Township: Bayfield			Stand: 6		Tons	Cords	MBF
Soil: Silt and Sand	Reforestation Code: N/A		Tract Number: 36-13	Mixed Hardwood	1789*	525*	12**
Topography: Gentle Rolling			Contract Number:	Aspen	790	252	
				Balsam Fir	270	68	
				Red Oak	115	29	

\* approx. 81% maple, 13% birch, 5% basswood, and 1% ash  
 \*\* approx. 46% oak, 33% maple, 17% birch, and 8% basswood

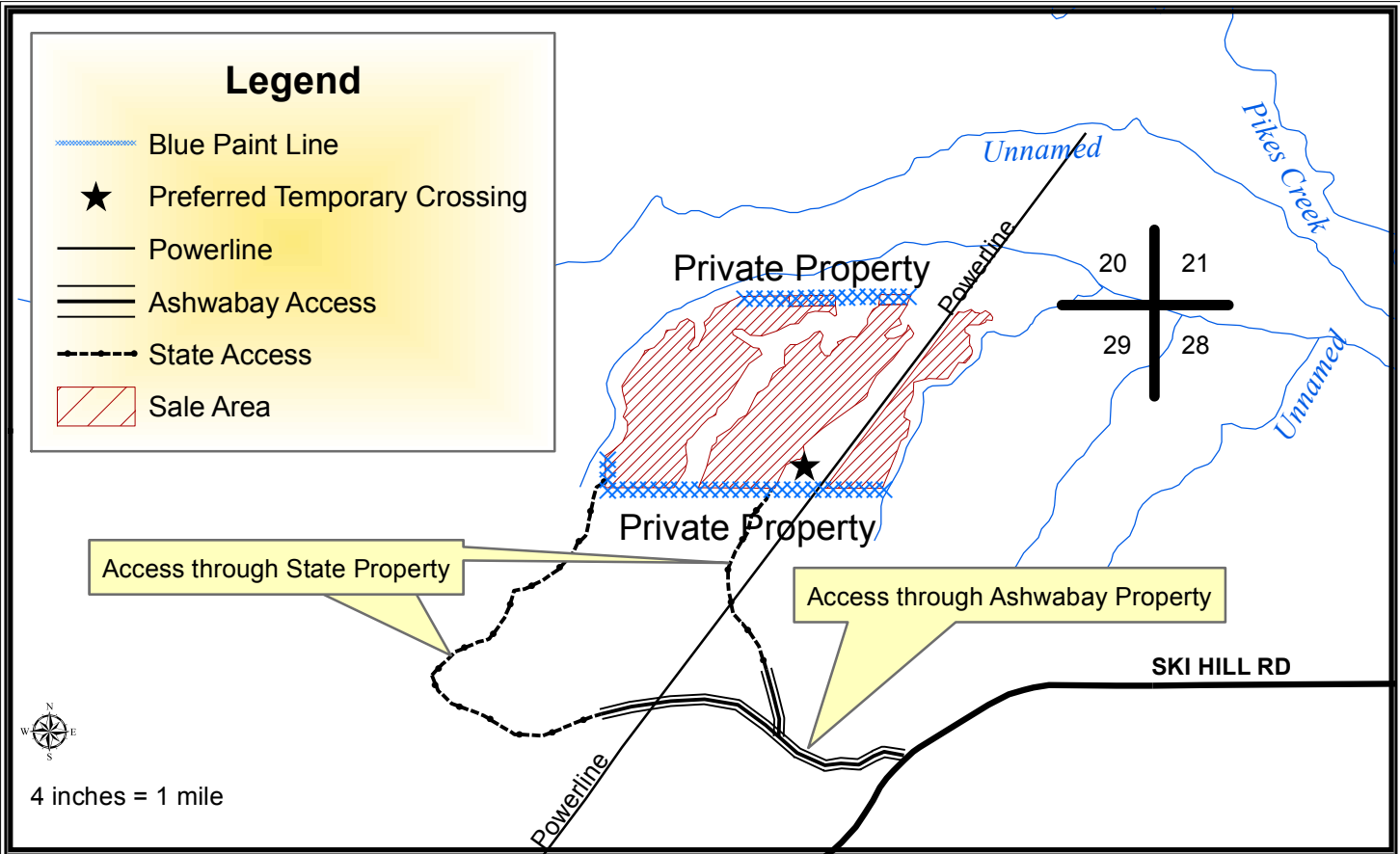

## Harvest Requirements:

- Sale is a clearcut being sold on a Ticket Scale Basis
- Boundaries consist of red paint line, blue paint line, or the powerline right of way.
- Harvest all merchantable balsam fir. Leave all other conifer.
- Harvest all merchantable hardwood EXCEPT purple marked trees.
- Sever all hardwood stems 2" in diameter and greater.
- Blue paint line indicates private property. No equipment or trees may cross the line.
- Do not cut snags except for those that pose a safety hazard.
- To comply with the Best Management Practices for Invasive Species: Prior to moving equipment onto or off of the sale area, scrape or brush soil and debris from exterior surfaces to the extent practical.
- Decking of wood along town roads will not be allowed without permission from Bayfield County.
- No decking wood or parking equipment on any State of Wisconsin Property.
- If harvest will utilize the whole tree, 1 in 10 tops must be left scattered throughout the sale.
- This contract requires County authorization for all road/landing construction and places a number of other requirements on road construction and closure.
- Access has been granted through State of Wisconsin Property and Ashwabay Outdoor Education Property as indicated on the map. These are recreational properties used on a regular basis, care must be used while using these roads
- To access the area east of the powerline a temporary crossing(pole ford or culvert) will need to be installed in a non-navigable drainage. The preferred location of the crossing is indicated by a star on the map.
- The Town of Bayfield has indicated that, if harvesting in the summer, hauling may be restricted to mornings only if daytime temperatures are expected to be hot.