

Bayfield County Forestry and Parks Department

Forester: Coonen/ LeBouton			Compartment: 162	Stand: 15	Tract Number: 39-19 Acres: 100
Twp: 45N	Range: 9W	Sec: 9	Township: Barnes	Contract Number:	
Topography: Gentle Rolling			Reforestation Code: None	Soil: Sand	

Estimated Volumes				*Average Diameter of 6 inches.
Species	4" Roundwood (Cords)	Whole Tree (Tons)	Sawlogs (MBF)	**Volume contains 88% Red Pine and 12% Jack Pine
Red Pine*	690**	1703		*** Volume contains 95% Aspen and 5% misc
Aspen***	30	87		

Special Restrictions:
Harvested pine cannot be kept on Bayfield County Forest for more than three weeks from May 1st to August 31st

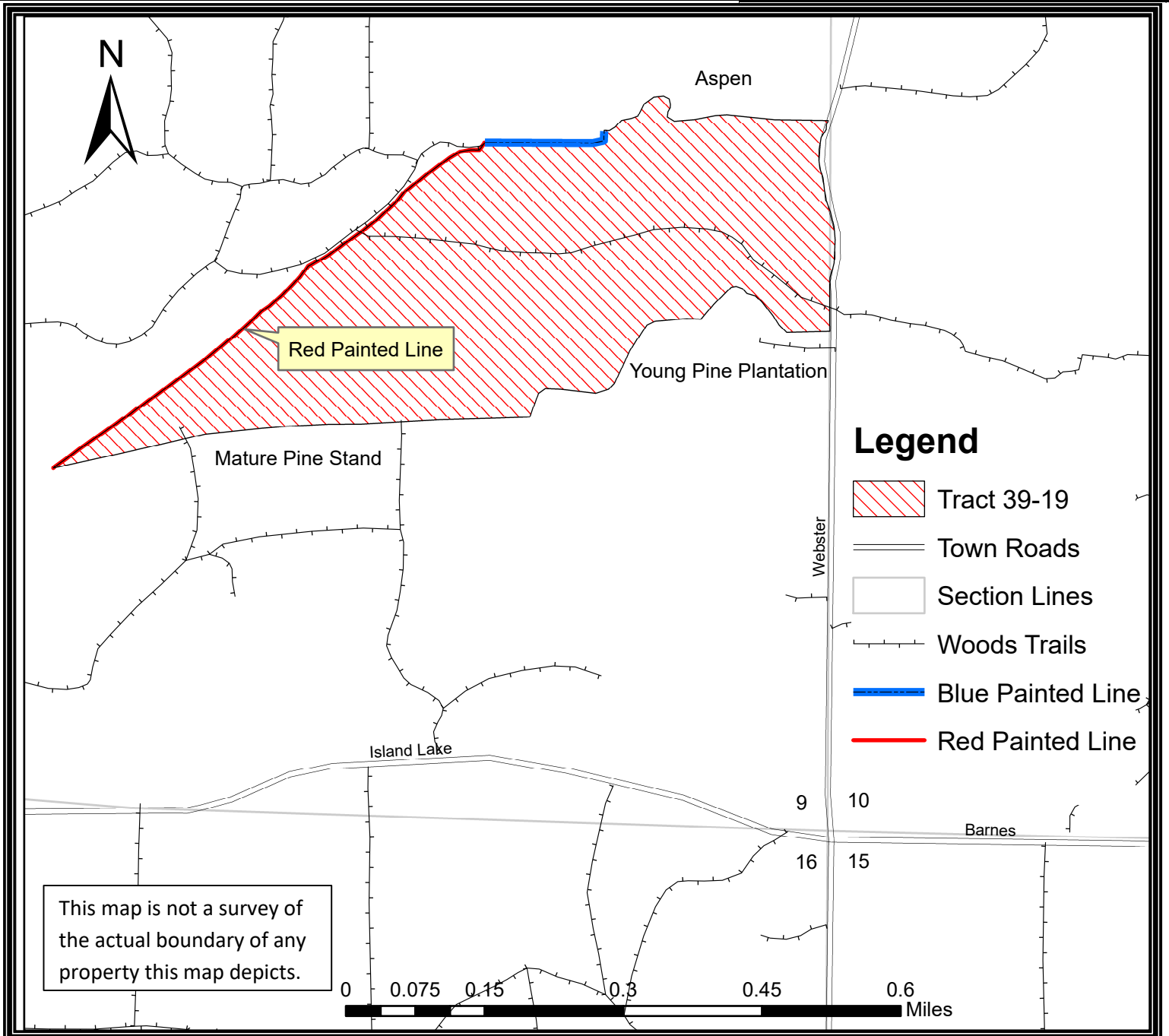

This map is not a survey of the actual boundary of any property this map depicts.

TRACT 39-19 – SUPPLEMENTAL REQUIREMENTS

The following terms and conditions supplement those provided in the Bayfield County Timber Sale Contract.

A. PRESCRIPTION:

1. The harvest unit has a thinning prescription with an estimated average residual basal area of 83 ft².

B. HARVEST REQUIREMENTS:

1. Cut all pine and other species in every third row (cut one row, leave two rows). Cut rows are not marked with paint. Logger will determine cut rows to the satisfaction of the Sale Administrator.
2. Leave and avoid damage to all residual trees.
3. Harvest all trees within 50' of Webster Road right of way.

C. OPERATIONAL REQUIREMENTS AND SEASONAL RESTRICTIONS:

1. Sale boundaries consist of red painted line along west, mature red pine stand to the south, freshly planted pine stand to the southeast, Webster road to the east, aspen to the north, and blue painted line to the North.
2. If harvest will utilize the whole tree, 1 in 10 tops must be left scattered throughout the sale.
3. Harvested pine cannot be kept on the Bayfield County Forest for more than three weeks from May 1st to August 31st.
4. Do not cut snags except for individuals that pose a safety hazard.

D. ACCESS AND ROADS:

1. This contract requires County authorization for all road/landing construction and places a number of other requirements on road construction and closure.
2. Decking of wood along town roads will not be allowed without permission from Bayfield County.

E. OTHER:

1. To comply with Best Management Practices for Invasive Species: Prior to moving equipment onto or off the sale area, scrape or brush soil and debris from exterior surfaces to the extent practical.
2. Do not damage any survey monumentation.

